

NOTE

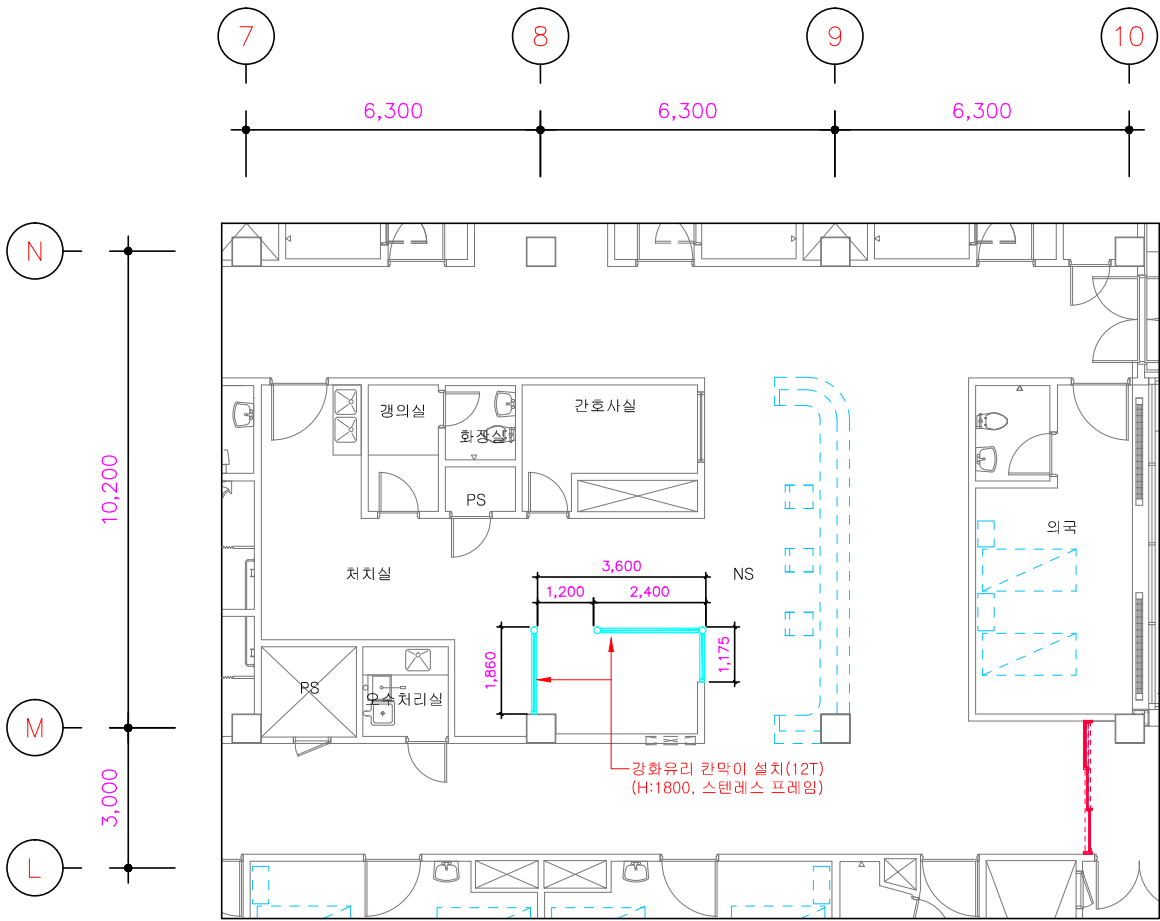

변경 전

변경 후

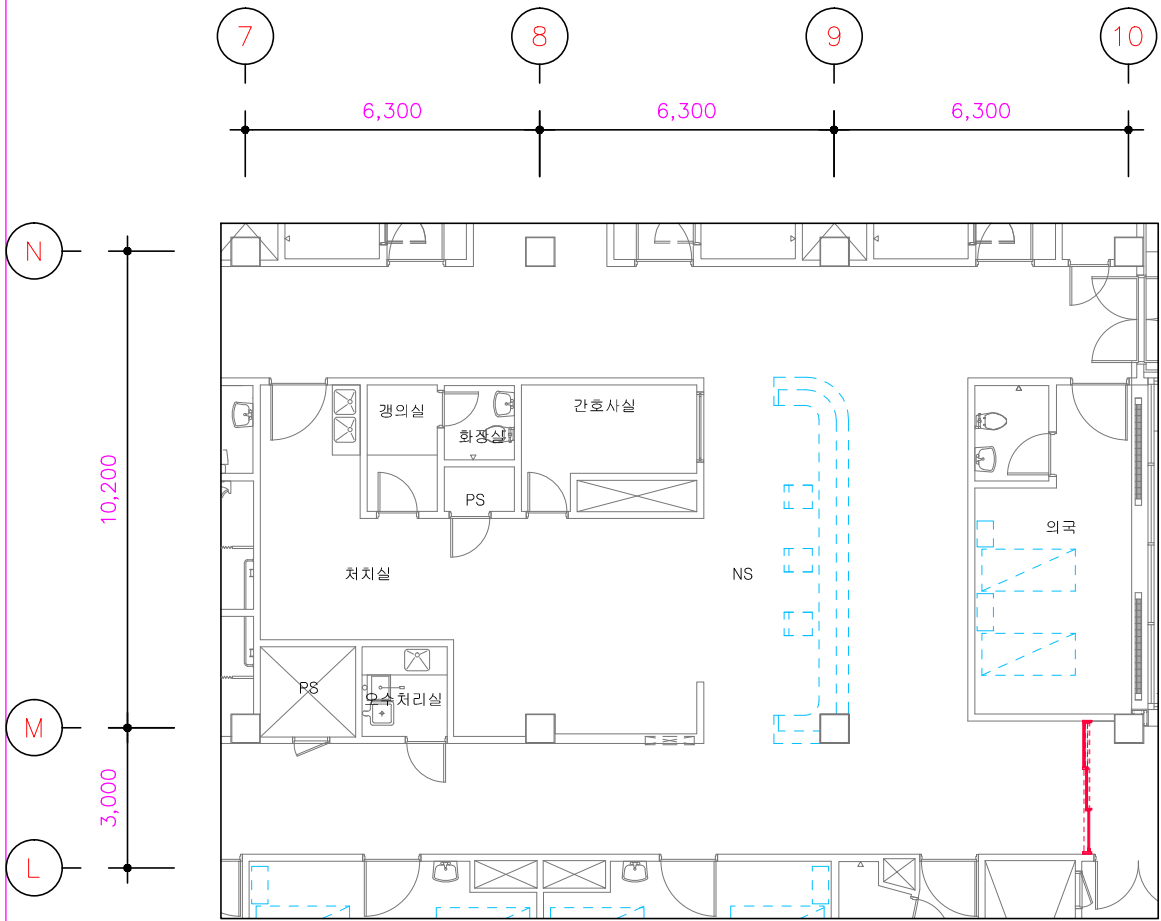
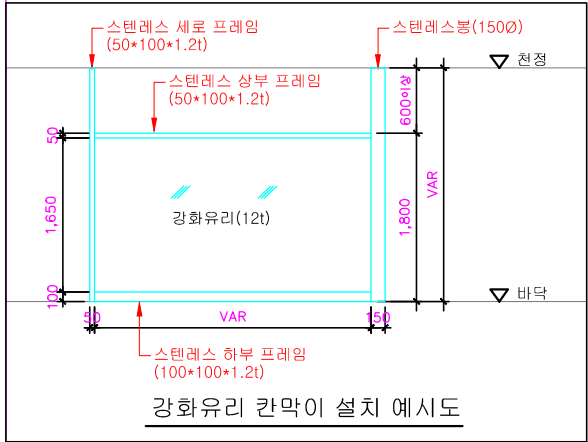

42병동 확대 평면도
축척 = 1/150

REV.	DESCRIPTION	DATE

설계명
PROJECT TITLE
강원대학교병원 병동 및
PICU 유리칸막이 설치 공사

설계구분
PROJECT KINDS

설계번호
PROJECT NO.

설계본부 / ENG:합력업체
담당 DRAWN BY: /
팀장 CHECKED BY: /
P.M. DESIGNED BY: /
PIC APPROVED BY: /

도면명칭
DRAWING TITLE
42병동 확대 평면도
축척 SCALE A1 : 1/ 75
A3 : 1/150
날짜 DATE: 2019. 10.

도면번호
SHEET NO.
A - 01

NOTE

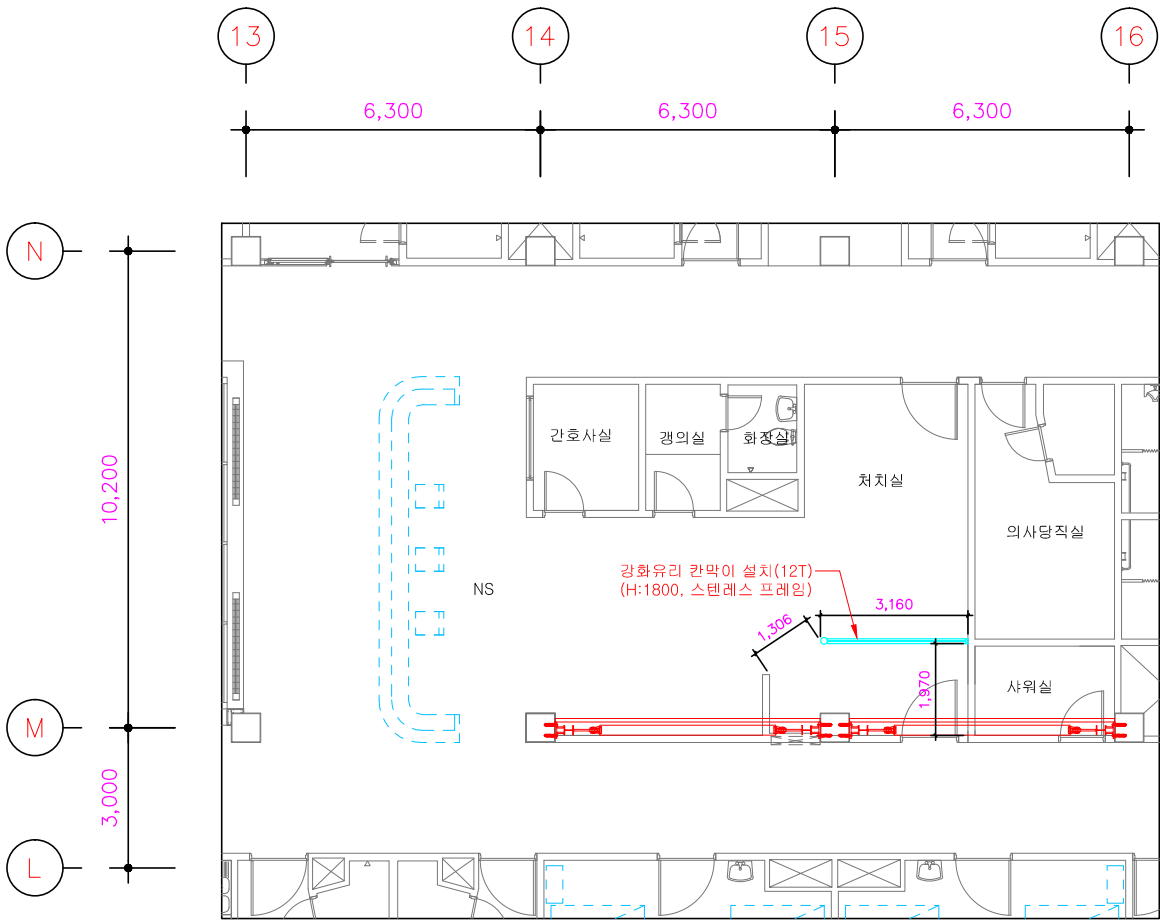
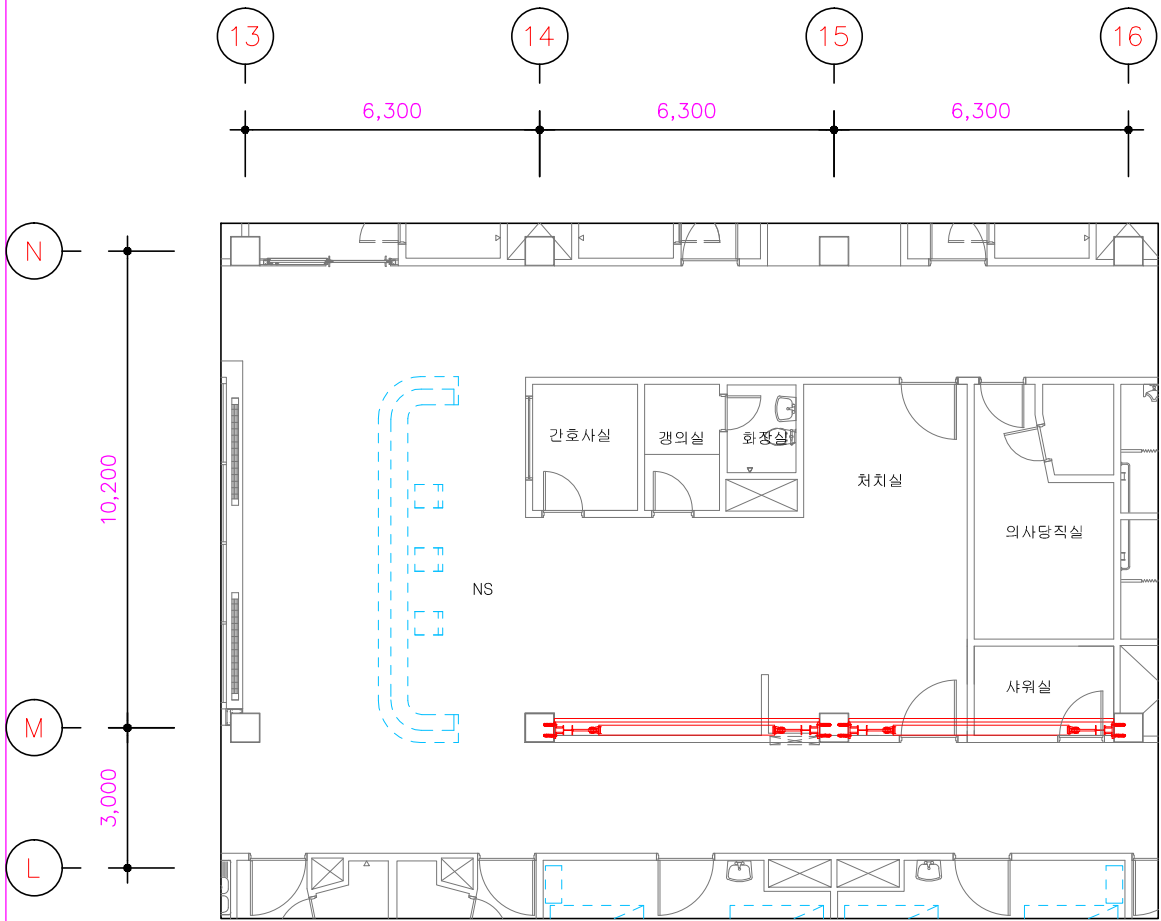

변경 전

변경 후

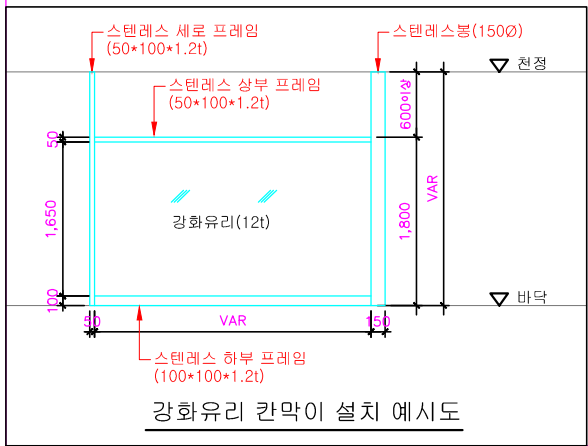

51병동 확대 평면도
축척 = 1/150

REV.	DESCRIPTION	DATE

설계명
PROJECT TITLE
강원대학교병원 병동 및
PICU 유리칸막이 설치 공사

설계구분
PROJECT KINDS

설계번호
PROJECT NO.

설계본부 / ENG:합력업체
담당 DRAWN BY: /
검정 CHECKED BY: /
P.M. DESIGNED BY: /
PIC APPROVED BY: /

도면명칭
DRAWING TITLE
51병동 확대 평면도
축척 SCALE A1 : 1/ 75
A3 : 1/150
날짜 DATE: 2019. 10.

도면번호
SHEET NO.
A - 02

NOTE

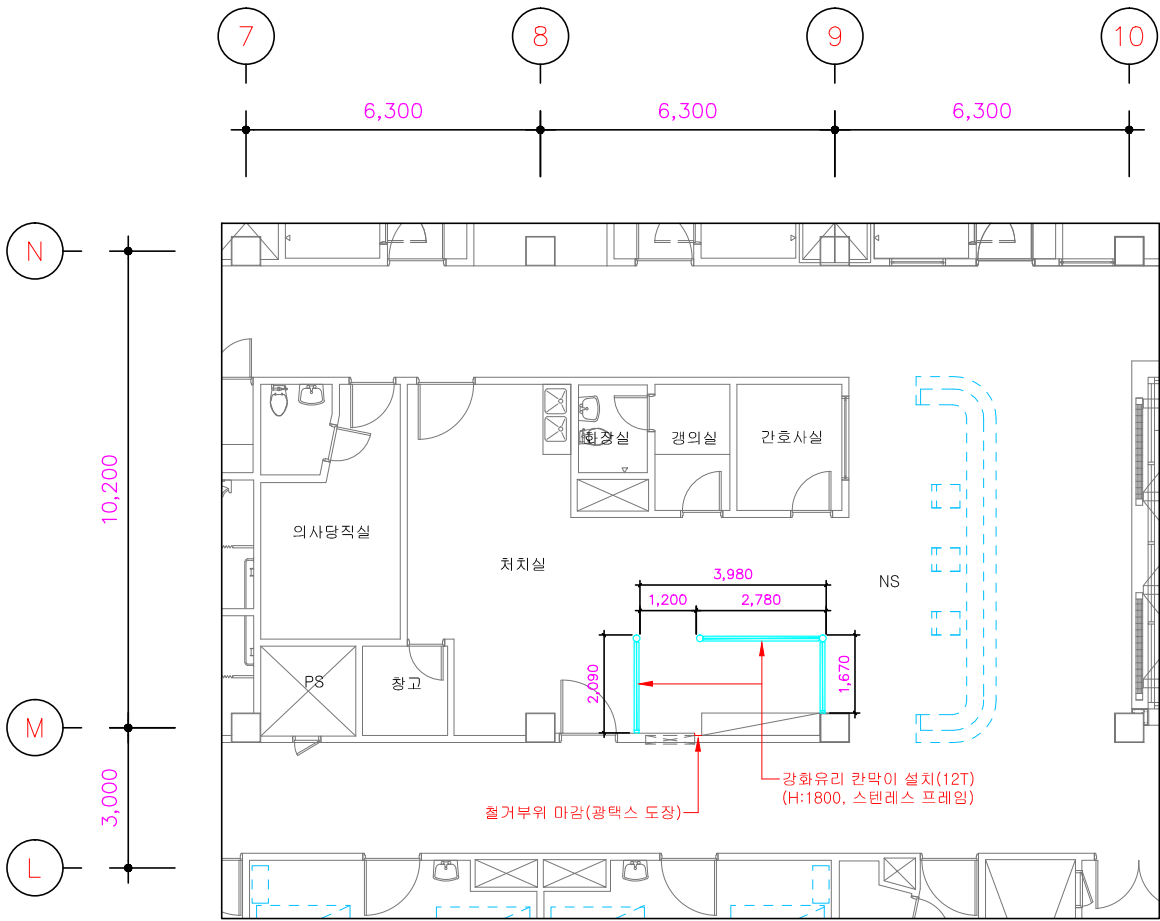
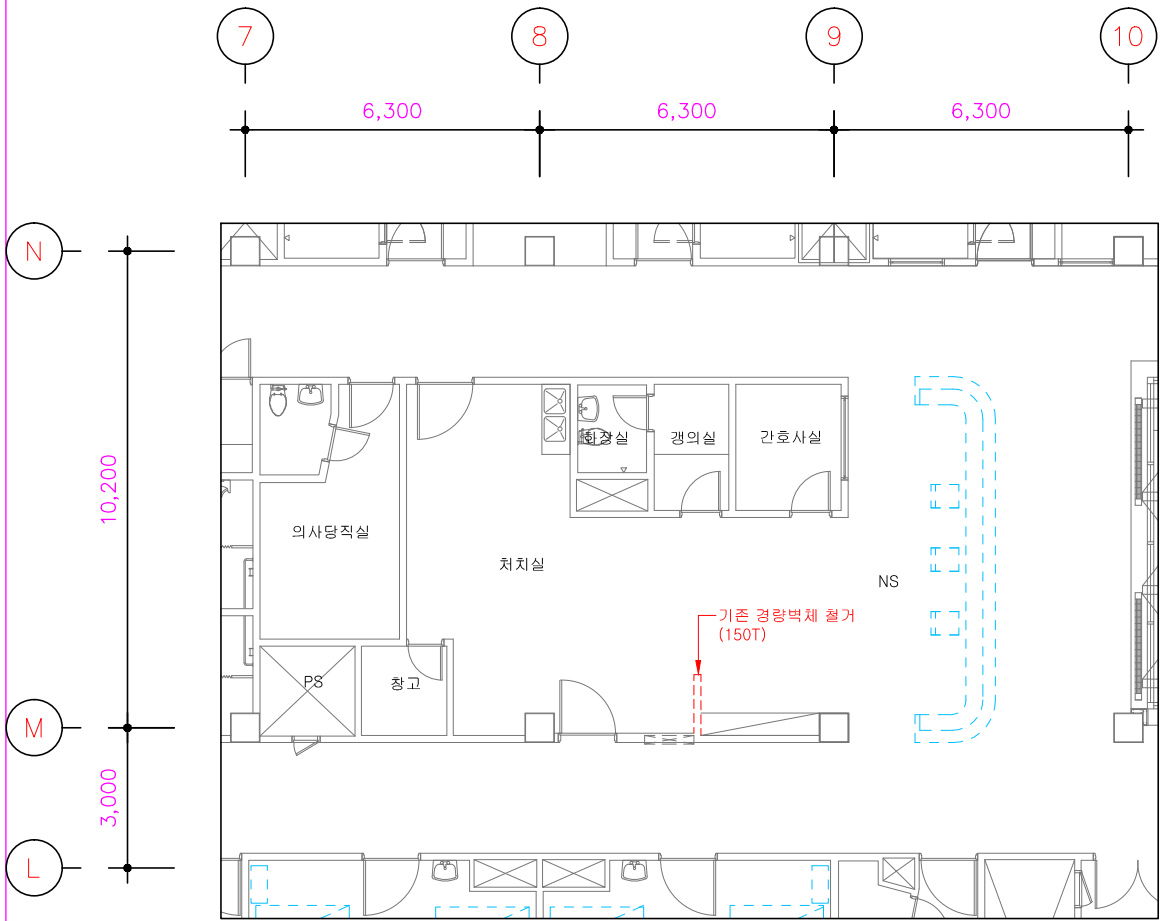

변경 전

변경 후

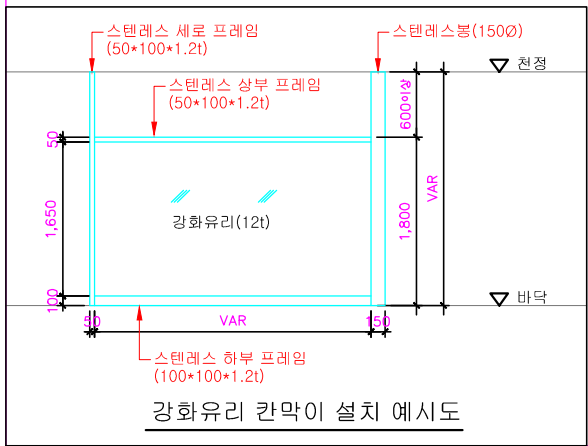

52병동 확대 평면도
축척 = 1/150

REV.	DESCRIPTION	DATE

설계명
PROJECT TITLE

강원대학교병원 병동 및
PICU 유리칸막이 설치 공사

설계구분
PROJECT KINDS

설계번호
PROJECT NO.

설계본부 / ENG:합력업체

담당 DRAWN BY: /

팀장 CHECKED BY: /

P.M. DESIGNED BY: /

PIC. APPROVED BY: /

도면명칭
DRAWING TITLE

52병동 확대 평면도

축척 SCALE A1 : 1/75 A3 : 1/150

날짜 DATE: 2019. 10.

도면번호
SHEET NO.

A - 03

NOTE

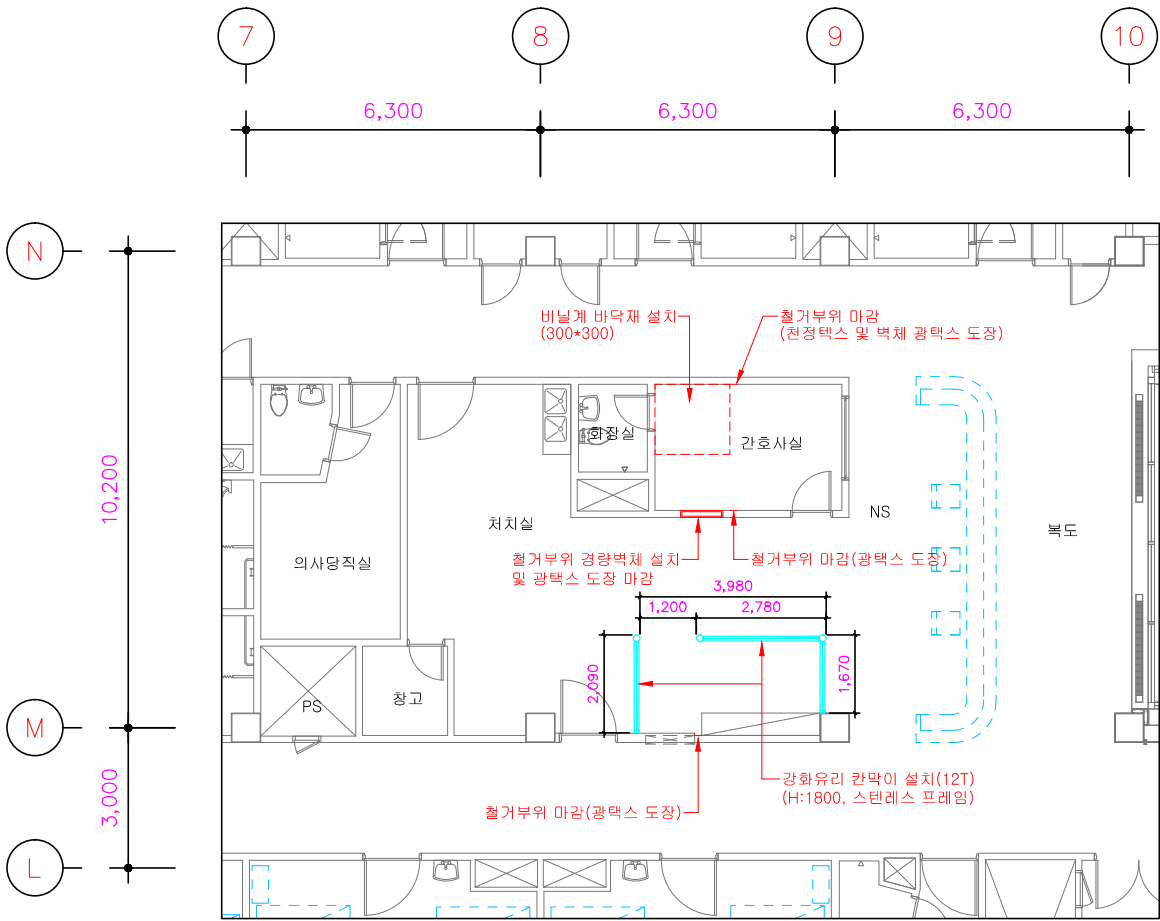
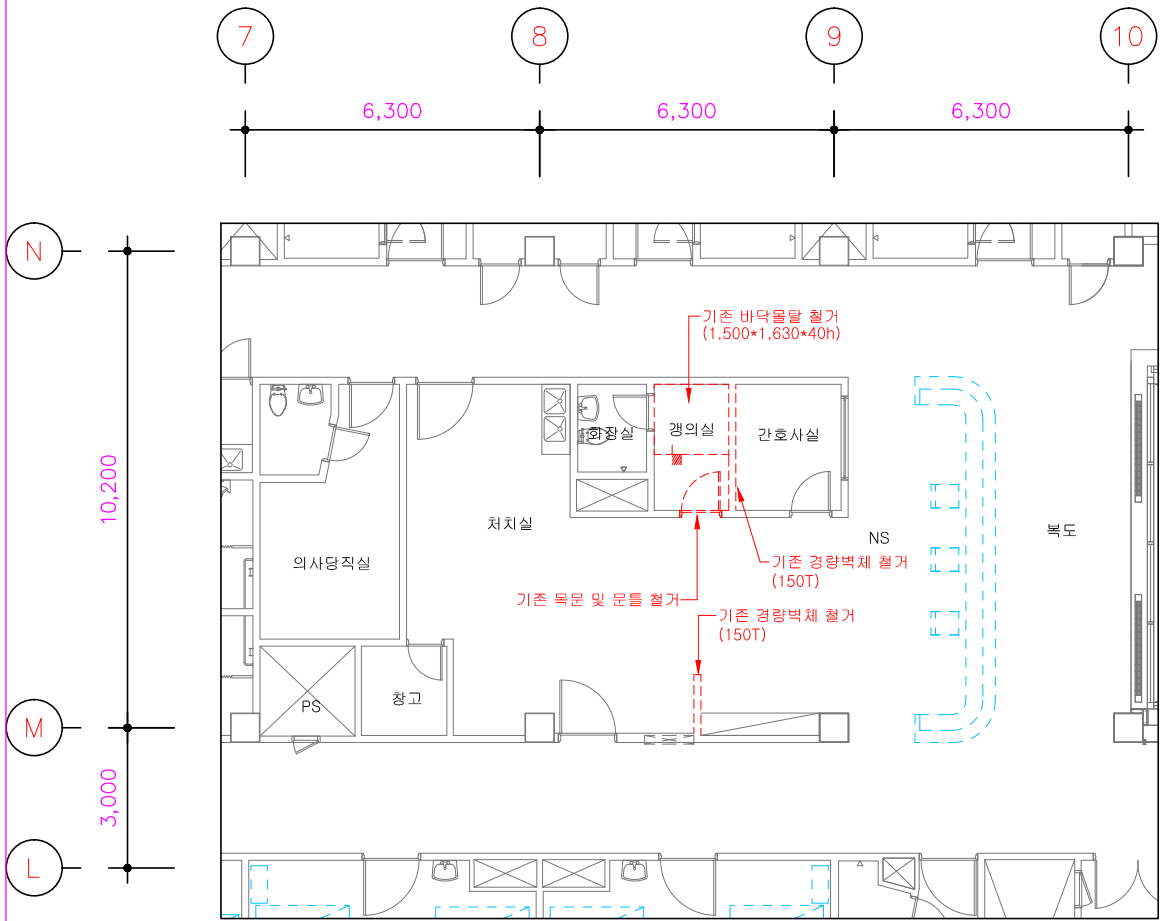

변경 전

변경 후

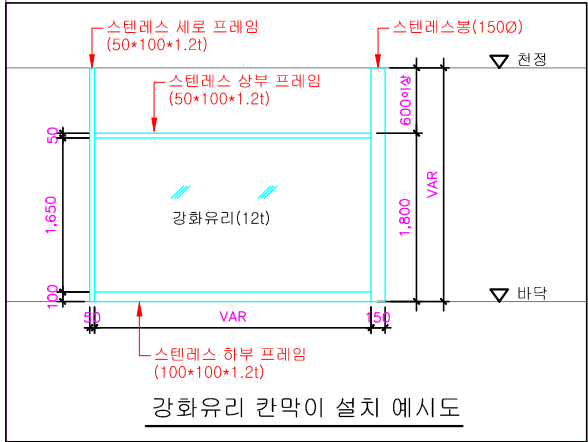

1
A 62병동 확대 평면도
축척 = 1/150

REV.	DESCRIPTION	DATE

변경 / 합의사항
REVISION

설계명
PROJECT TITLE
강원대학교병원 병동 및
PICU 유리칸막이 설치 공사

설계구분
PROJECT KINDS

설계번호
PROJECT NO.

설계부 / ENG:합력업체
담당 DRAWN BY: /
검정 CHECKED BY: /
P.M. DESIGNED BY: /
PIC APPROVED BY: /

도면명
DRAWING TITLE 62병동 확대 평면도
축척 SCALE A1 : 1/ 75
A3 : 1/150
날짜 DATE: 2019. 10.

도면번호
SHEET NO.

A - 04

NOTE

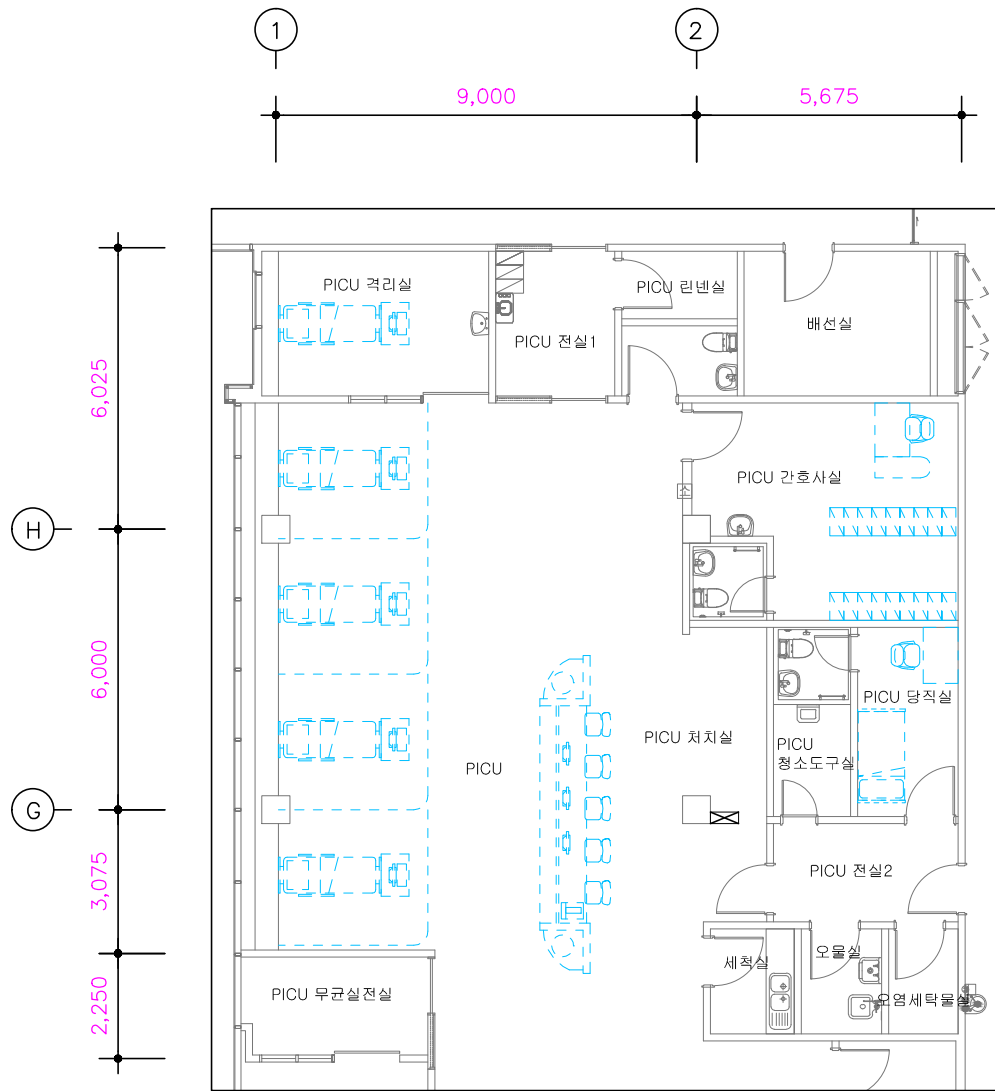

변경 전

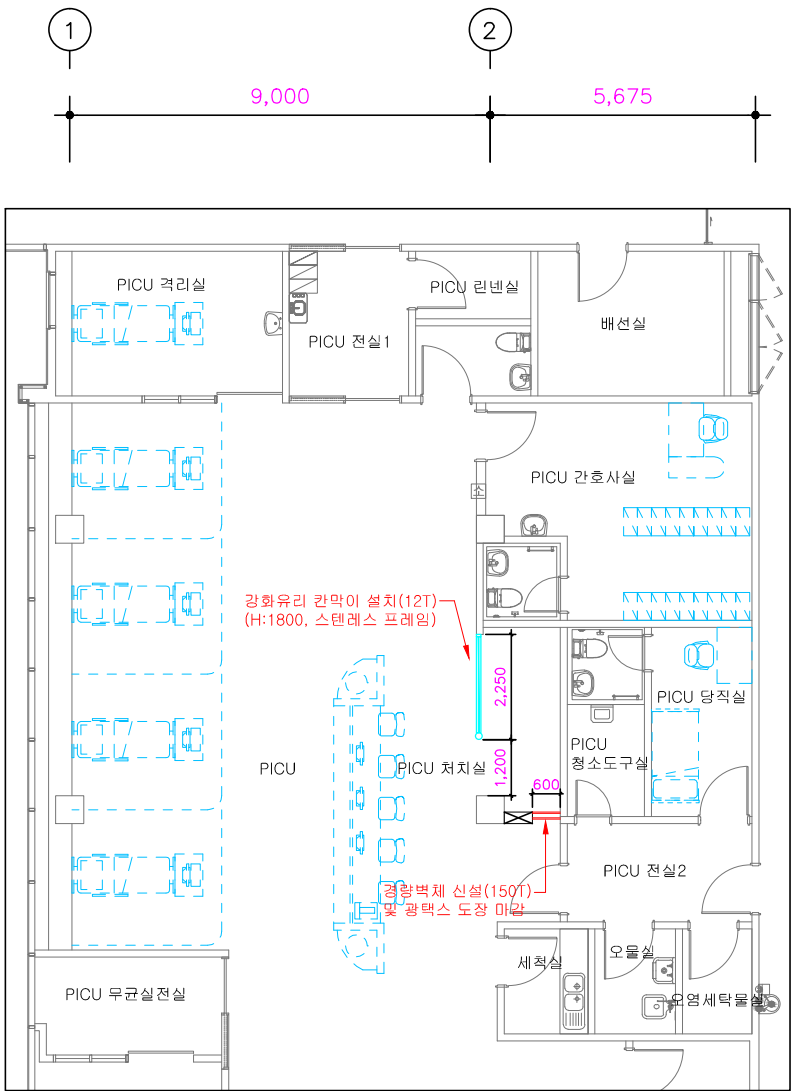

변경 후

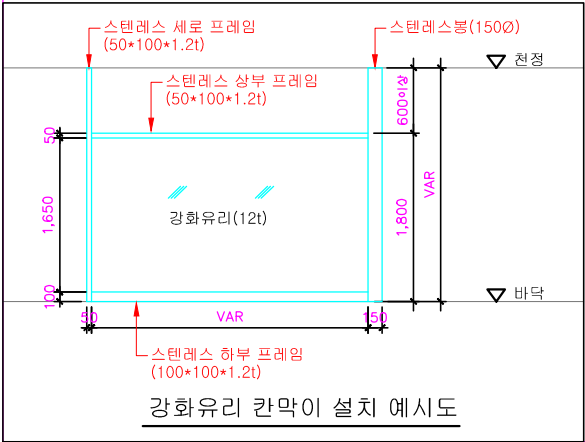

1
A PICU 확대 평면도
축척 = 1/150

REV.	DESCRIPTION	DATE

설계명
PROJECT TITLE

강원대학교병원 병동 및
PICU 유리칸막이 설치 공사

설계구분
PROJECT KINDS

설계번호
PROJECT NO.

설 계 부 / ENG:합력업체
담당 DRAWN BY: /
팀장 CHECKED BY: /
P.M. DESIGNED BY: /
PIC APPROVED BY: /

도면명칭
DRAWING TITLE PICU 확대 평면도
축척 SCALE A1 : 1/ 75 날짜 DATE: 2019. 10.
A3 : 1/150

도면번호
SHEET NO.

A - 05